

Archaeological Evaluation of Land at Days Yard, Shaftesbury Road, Whitstable, Kent



NGR: 610603 166352

Site Code: DAY/EV/18

(Planning Application: APP/12210/W/3178561)

SWAT Archaeology

The Office, School Farm Oast

Graveney Road Faversham, Kent, ME13 8UP

Email: info@swatarchaeology.co.uk

Tel.: 01795 532548 and 07885 700112

© SWAT Archaeology 2018 all rights reserved

Contents

List of Figures.....	3
List of Plates.....	3
1. Summary.....	4
2. Introduction.....	4
3. Site Description and Topography.....	4
4. Planning Background.....	5
5. Archaeological and Historical Background.....	5
6. Aims and Objectives.....	5
7. Methodology.....	6
8. Monitoring.....	6
9. Results.....	6
10. Discussion.....	8
11. Finds.....	8
12. Conclusion.....	8
13. Acknowledgements.....	8
14. References.....	8
15. CCC Summary Form.....	9

List of Figures:

Figures 1-3 –Location of site and evaluation trenches

List of Plates:

Plate 1 - Aerial view of site (Google Earth)

Plate 2 – Trench 1 (looking NNE)

Plate 3 – Trench 2 (looking N)

Plate 4 – Trench 2

Plate 5 – Trench 3

Plate 6 – Trench 3 (looking west)



Plate 1. Aerial photograph of site (9/4/2017) Google Earth

Archaeological Evaluation of Land at Days Yard, Shaftesbury Road, Whitstable, Kent

NGR: 610603 166352

Site Code: DAY-EV-18

1. Summary

Swale & Thames Survey Company (SWAT) carried out an archaeological evaluation of land at Days Yard, Shaftesbury Road, Whitstable in Kent. A Planning Application (APP/12210/W/17/3178561) to develop this site for a terrace of 4 x 1 bedroom mews houses, covered car parking, cycle storage and refuse storage areas to Canterbury City Council, whereby the Council requested that an Archaeological Evaluation be undertaken in order to determine the possible impact of the development on any archaeological remains. The work was carried out in accordance with the requirements set out within an Archaeological Specification (SWAT Specification A and CCC Manual Part B) and in discussion with the Archaeological Heritage Officer, Canterbury City Council. The results of the excavation of three evaluation trenches revealed that no archaeological features were present within the trenches (Figures 1-3). The natural geology of London Clay was reached at an average depth of between 0.40m and 0.55m below the Yard's top layer of flint and chalk nodules mixed with clay. The Archaeological Evaluation has been successful in fulfilling the primary aims and objectives of the Archaeological Specification.

2. Introduction

Swale & Thames Survey Company (SWAT) was commissioned by the landowners to carry out an archaeological evaluation at the above site. The work was carried out in accordance with the requirements set out within an Archaeological Specification (SWAT 2018) and in discussion with Rosanne Cummings, Archaeological Heritage Officer, Canterbury City Council. The evaluation was carried out on the 25th July 2018.

3. Site Description and Topography

The proposed development area (PDA) is located within the Whitstable Conservation Area close to Cornwallis Circle and Shaftesbury Road in Whitstable. The site is an area of land occupied by a former commercial use; with a row of garages along its southern side and a

large commercial building in the north eastern corner of the site. The OS location is NGR 610603 166352 (Figure 1).

3.1 The Geological Survey of Great Britain (1:50,000) shows that the PDA is set on Bedrock Geology of London Clay Formation- Clay and Silt.

3.2. Superficial deposits are recorded as Alluvium- Clay, Silt, Sand and Peat.

3.3. The PDA is located in an area of very little known archaeological activity (Figure 3). The KCCHER data indicated that no archaeology is known within the proposed development area (PDA) apart from a number of listed buildings in the vicinity of the PDA.

4. Planning Background

Canterbury City Council gave planning permission has been obtained on appeal with the following Condition (12):

No development shall take place until the applicant, or their agents or successors in title, has secured the implementation of:

(i) An archaeological field evaluation works in accordance with a specification and:

(ii) A written timetable which has first been submitted to and approved in writing by the Local Planning Authority; and,

(ii) following on from the evaluation, any safeguarding measures to ensure preservation in situ of important archaeological remains and/or further archaeological investigation, post excavation assessment, analysis, publication or conservation in accordance with a specification and timetable which has been submitted to and approved in writing by the Local Planning Authority. Thereafter, any such archaeological works shall take place in accordance with the approved details.

The results from this evaluation will be used to inform CCC Archaeology and Heritage and Canterbury City Council of any further archaeological mitigation measures that may be necessary in connection with the development proposals.

5. Archaeological and Historical Background

The Archaeological record shows the site is located in an area of very little known archaeological activity. The KCCHER data indicated that no archaeology is known within the proposed development area (PDA) apart from a number of listed buildings in the vicinity of the PDA.

6. Aims and Objectives

According to the SWAT Archaeological Specification, the aims and objectives for the archaeological work were to ensure that:

The principle objective of the archaeological evaluation is to establish the presence or otherwise of any elements of the archaeological resource, both artefacts and ecofacts of archaeological interest across the area of the development.

To ascertain the extent, depth below ground surface, depth of deposit if possible, character, date and quality of any such archaeological remains by limited sample excavation.

To determine the state of preservation and importance of the archaeological resource if present and to assess the past impacts on the site and pay particular attention to the character, height/depth below ground level, condition, date and significance of any archaeological deposits.

The opportunity will also be taken during the course of the evaluation to place and assess any archaeology revealed within the context of other recent archaeological investigations in the immediate area and within the setting of the local landscape and topography.

Should archaeological remains be found, further archaeological excavation may be required. This work will be covered by a separate specification and not form part of the present evaluation.

7. Methodology

The Archaeological Specification called for an evaluation by trial trenching comprising a first phase of three trenches 25m long and 1.8m wide within the footprint of the proposed housing development. An 8.5 ton 360° tracked mechanical excavator with a flat-bladed ditching bucket was used to remove the topsoil and subsoil to expose the natural geology.

All archaeological work was carried out in accordance with the specification. A single context recording system was used to record the deposits, and context recording numbers were assigned to all deposits for recording purposes. All archaeological work was carried out in accordance with CCC, SWAT and ClfA standards and guidance.

8. Monitoring

Curatorial monitoring was available during the course of the evaluation.

9. Results

The evaluation has identified no archaeological features within the three trenches (Figures 1-3).

Trench 1

Trench 1 was ENE-WSW aligned and located alongside northern boundary of the site at altitude of 3.34m O.D. It measured 25m by 1.8m and was excavated to the depth of 0.5m.

At the bottom of the trench natural deposit of London clay (103) was exposed successively overlaid by 0.3m thick subsoil – levelling layer (102) and 0.2m thick top – yard layer (101).

Yard's top layer (101) was compacted, dark brown clayey silt with freq angular stones (flint and chalk).

Levelling layer (102) was firmly compacted, mid brown silty clay with moderate sub angular flints

Natural- London Clay was firmly compacted mid greyish brown clay with occ. flint.

Trench 2

Trench 2 was NE-SW aligned and located in the central part of the site at altitude of 3.35m O.D. It measured 25m by 1.8m and was excavated to the depth of 0.5m.

At the bottom of the trench natural deposit of London clay (203) was exposed successively overlaid by 0.3m thick subsoil – levelling layer (202) and 0.2m thick top – yard layer (201).

Yard's top layer (201) was compacted, dark brown clayey silt with freq angular stones (flint and chalk).

Levelling layer (202) was firmly compacted, mid brown silty clay with moderate sub angular flints

Natural- London Clay (203) was firmly compacted mid greyish brown clay with occ. flint.

Trench 3

Trench 3 was E-W aligned and located in the central part of the site at altitude of 3.29m O.D. It measured 25m by 1.8m and was excavated to the depth of 0.5m.

At the bottom of the trench natural deposit of London clay (303) was exposed successively overlaid by 0.3m thick subsoil – levelling layer (302) and 0.2m thick top – yard layer (301).

Yard's top layer (301) was compacted, dark brown clayey silt with freq angular stones (flint and chalk).

Levelling layer (302) was firmly compacted, mid brown silty clay with moderate sub angular flints

Natural- London Clay (303) was firmly compacted mid greyish brown clay with occ. flint.

10. Discussion

With a number of archaeological sites known in the vicinity of the PDA it was expected that the evaluation may produce evidence of archaeological activity. But there was none. The site has been used as a yard. All trenches showed a typical sequence of top cover and subsoil.

11. Finds

No finds were found.

12. Conclusion

The evaluation trenches at the proposed development site revealed no archaeological features or artefacts.

The archaeological evaluation has been successful in fulfilling the primary aims and objectives of the Specification. A common stratigraphic sequence was recognised across the site comprised of topsoil **(101)** sealing the subsoil **(102)**. Therefore, this evaluation has been successful in fulfilling the aims and objectives as set out in the planning condition and the Archaeological Specification.

13. Acknowledgements

SWAT Archaeology would like to thank the client for commissioning the project. Thanks are also extended to Rosanne Cummings Archaeological Heritage Officer, Canterbury City Council. The fieldwork was undertaken by Tim Allen MCIfA and the report written by Paul Wilkinson MCIfA.

Dr Paul Wilkinson 28/09/2018

14. References

Chartered Institute for Field Archaeologists (CIfA), Rev (2017). *Standard and Guidance for archaeological field evaluation*

SWAT Archaeology (2018) *Site Specific Requirements: Days Yard, Shaftsbury Road, Whitstable, Kent*

KCC and Historic England HER data 2018

Kent County Council HER Summary Form

Site Name: Land at Days Yard, Shaftsbury Road, Whitstable, Kent

SWAT Site Code: DAY/EV/18

Site Address: As above

Summary:

Swale and Thames Survey Company (SWAT) carried out Archaeological Evaluation on the development site above. The site has planning permission for a residential housing whereby Canterbury City Council Heritage and Conservation requested that Archaeological Evaluation be undertaken to determine the possible impact of the development on any archaeological remains. The Archaeological Monitoring consisted of an Archaeological Evaluation which revealed no archaeology.

District/Unitary: Canterbury City Council

Period(s):

NGR (centre of site to eight figures) 610603 166352

Type of Archaeological work: Archaeological Evaluation

Date of recording: 25th July 2018

Unit undertaking recording: Swale and Thames Survey Company (SWAT. Archaeology)

Geology: Underlying geology is Bedrock Geology of London Clay Formation

Title and author of accompanying report: Wilkinson P. (2018) Archaeological Evaluation of Land at Days Yard, Shaftsbury Road, Whitstable, Kent

Summary of fieldwork results (begin with earliest period first, add NGRs where appropriate)

No archaeology found

Location of archive/finds: SWAT. Archaeology. Graveney Rd, Faversham, Kent. ME13 8UP

Contact at Unit: Paul Wilkinson



Plate 2. Trench 1 (looking NE)



Plate 3. Trench 2 (looking SSW)



Plate 4. Trench 2 and view of site (looking north)



Plate 5. Trench 3

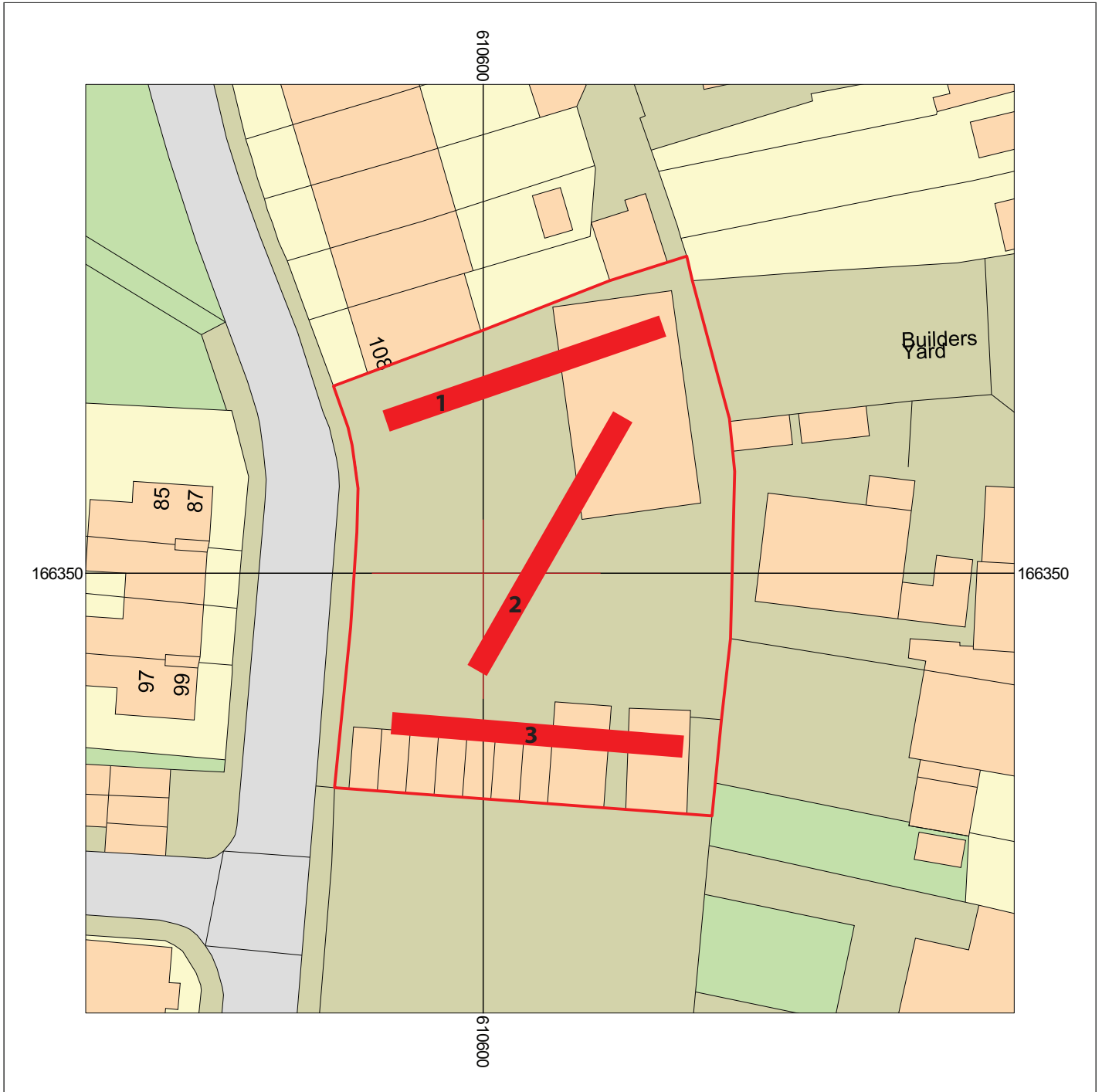

Plate 6. Trench 3 (looking west)



Figure 1: Site location map, scale 1:10000.

OS Plan Colour



© Crown copyright and database rights 2018. OS 100031961

Day's Yard
Whitstable
CT5 1DS

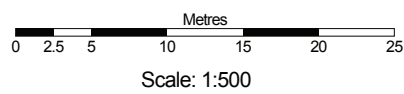

Figure 2: Trench location in relation to OS map, scale 1:500.

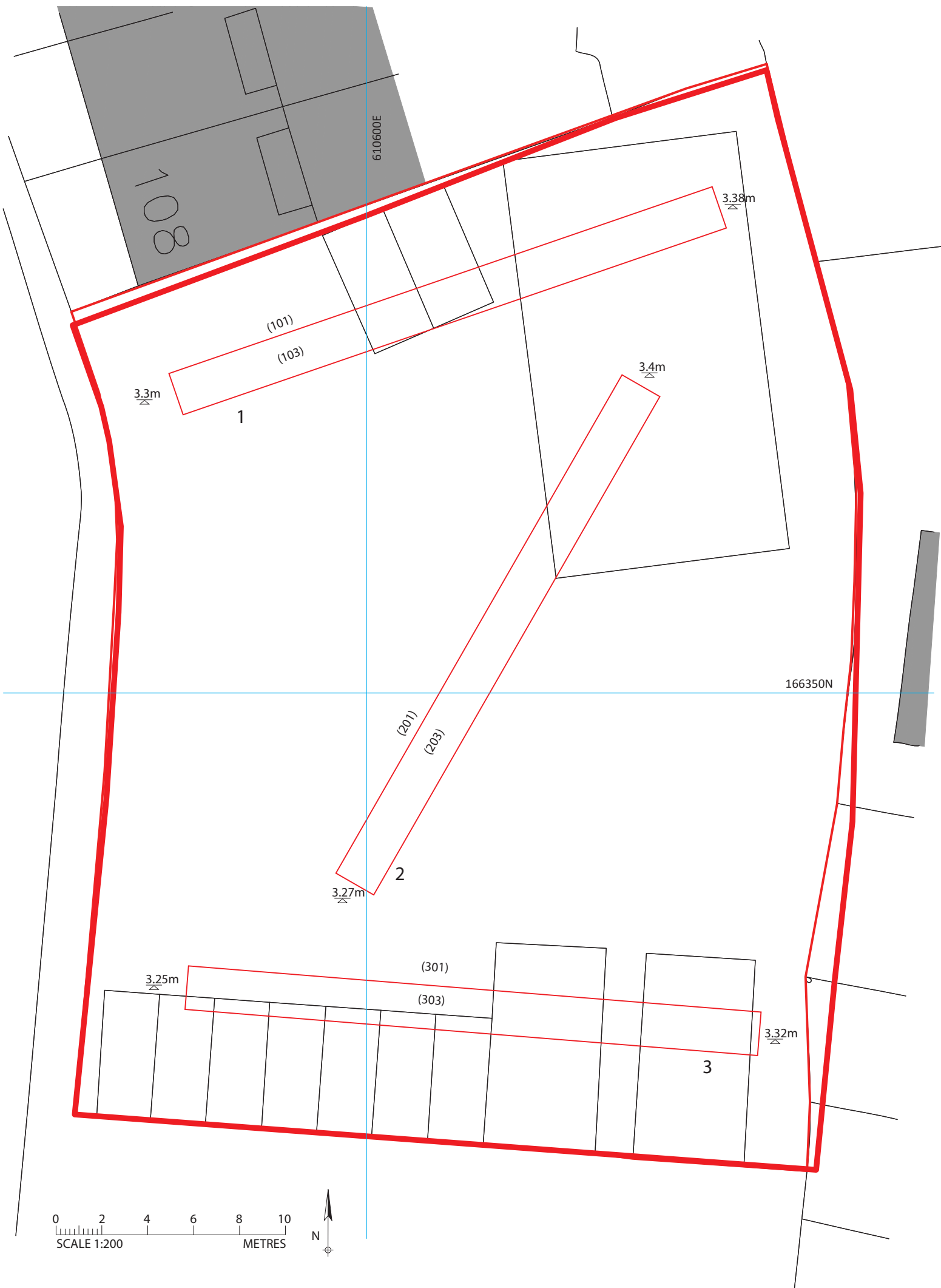

Figure 3: Trench plan, scale 1:200.



Figure 4: Trench location in relation to proposed development, scale 1:500.